



DMCPA7MW

QUICK START GUIDE

Media Receiver with Android Auto™ and Apple CarPlay®
featuring a 7" digital TFT Display



maestro
This Quick Start Guide is the basics to start using your DMC. Please visit www.dualav.com to download a complete owner's manual or call customer service at 1-866-382-5476 (Monday-Friday, 9AM-5PM EST).



Customer Service Toll Free: 1-866-382-5476

Installation

Before You Start

- Disconnect negative battery terminal. Consult a qualified technician for instructions.
- Avoid installing the unit where it would be subject to high temperatures, such as from direct sunlight, or where it would be subject to dust, dirt or excessive vibration.

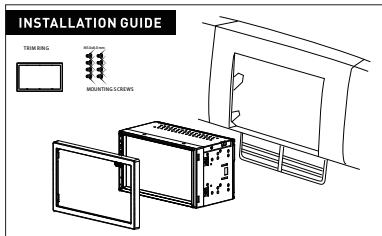

Control Locations

The radio display features the following functions and displays:

- 1 Power
- 2 Mute
- 3 Volume Up/Down
- 4 Push Voice Activation
- 5 Reset



Main Menu

In main menu, press the desired icon to enter the corresponding mode: AM/FM/Bluetooth Phone/Bluetooth Audio/Apple CarPlay/Android Auto/USB/Camera/EQ/AV In/Settings/Car Info



Tuner Operation

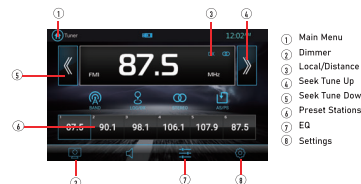

- 1 Main Menu
- 2 Dimmer
- 3 Local/Distance
- 4 Seek Tune Up
- 5 Seek Tune Down
- 6 Preset Stations AM/FM
- 7 EQ
- 8 Settings

SiriusXM® Satellite Radio Operation

From the main menu, touch the XM icon on the main screen.

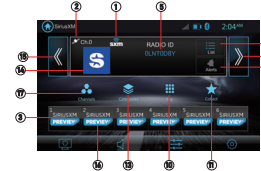

- 1 Band Selector
- 2 Satellite Strength
- 3 BAND Presets 1-6
- 4 Channel Info
- 5 Title Information
- 6 Additional Options
- 7 Favorites Alert
- 8 Equalizer
- 9 Direct Channel Entry
- 10 Channel / Album Artwork

USB Operation

From the main menu, touch the USB icon on the main screen.

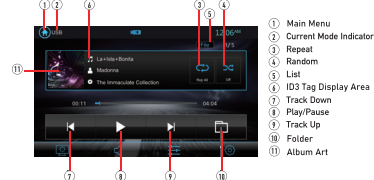

- 1 Main Menu
- 2 Current Mode Indicator
- 3 Repeat
- 4 Random
- 5 List
- 6 ID3 Tag Display Area
- 7 Track Down
- 8 Play/Pause
- 9 Track Up
- 10 Folder

Audio Operation

Select from the below 3 icons in the Settings menu to select between Balance, Fader and Time Alignment Settings, EQ Presets and 10-Band EQ Settings or Surround Settings.



Screen Operation

Press the Monitor icon in the Settings menu to access the Brightness, Contrast, Button Illumination Colors and Wallpaper Settings.



General Operation

Press the Function icon in the Settings menu to access the Time Zone, Date and Time and other radio Settings.



Adjusting Front and Rear Camera Screen Image

If your front or rear cameras appear to have a reversed image on the radio's display, go into the Camera section in the Settings menu to reverse the image of the camera. To do this, toggle the "Rear Camera View Reverse" or "Front Camera View Reverse" function to correct the viewing angle of the camera(s).

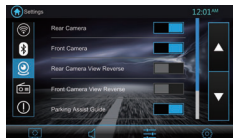

Wired & Wireless Apple CarPlay Operation

Wired connection

- 1 Connect an Apple CarPlay compatible device to this unit via USB.
- 2 Press the Apple CarPlay icon.

The Apple CarPlay home screen appears.

Wireless connection

Before using Apple CarPlay wirelessly, turn on the Bluetooth/WiFi function on the Phone.

- 1 Press the icon on the main menu.
- 2 Press the icon to confirm to use wireless Apple CarPlay.
- 3 Press the icon to search phone device. The available devices appear on the list.
- 4 Find the desired device on the screen and press "Pair".
- 5 A pass key will be displayed on the screen.
- 6 The same key appears on the iPhone, press "Pair" and then press "Allow" for the popups.
- 7 Press the icon on the screen to confirm to connect.
- 8 Press "Use CarPlay" on the iPhone. The unit configures the connection then starts the application.

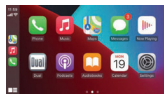

Wired & Wireless Android Auto™ Operation

Wired connection

- 1 Connect an Android Auto™ compatible device to this unit via USB.
- 2 Press the Android Auto icon.

The Android Auto home screen appears.

Wireless connection

Before using Android Auto wirelessly, turn on the Bluetooth/WiFi function on the Android device.

- 1 Press the icon on the main menu.
- 2 Press the icon to confirm to use wireless Android Auto.
- 3 Press the icon to search phone device. The available devices appear on the list.
- 4 Find the desired device on the screen and press "Pair".
- 5 A pass key will be displayed on the screen.
- 6 The same key appears on the Android device, press "Pair" and then press "Allow" for the popups.
- 7 Press the icon on the screen to confirm to connect.
- 8 The unit configures the connection then starts the application.

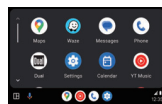

Press the OEM Setting to access the Maestro function.



Limited One Year* Warranty

This warranty gives you specific legal rights. You may also have other rights which vary from state to state. Dual Electronics Corp. Inc warrants this product to the original purchaser to be free from defects in material and workmanship for a period of one year from the date of the original purchase. Dual Electronics Corp. Inc agrees, at our option, during the warranty period, to repair any defect in material or workmanship or to furnish an equal new, renewed, or comparable product (whichever is deemed necessary) in exchange without charges, subject to verification of the defect or malfunction and proof of the date of purchase. Subsequent replacement products are warranted for the balance of the original warranty period.

What is covered? This warranty covers all defects in the material and workmanship in this product. The following are not covered: software, installation/removal costs, damage resulting from accident, misuse, abuse, neglect, product modification, improper installation, incorrect line voltage, unauthorized repair, or failure to follow instructions supplied with the product, or damage occurring during return shipment of the product. Specific license conditions and copyright notices for the software can be found via www.dualav.com.

Warranty Coverage

* Limited 1-year warranty. (Proof of purchase required)
Extend your warranty from 1 year to 2 years when you register online at www.dualav.com.

What to do?

1. Before you call for service, check the troubleshooting guide in your owner's manual. A slight adjustment of any custom controls may save you a service call.
 2. If you require service during the warranty period, you must carefully pack the product (preferably in the original package) and ship it by prepaid transportation with a copy of the original receipt from the retailer to an authorized service center.
 3. Please describe your problem in writing and include your name, a return UPS shipping address (P.O. Box not acceptable), and a daytime phone number with your shipment.
 4. For more information and for the location of the nearest authorized service center please contact us by one of the following methods:
 - Call us toll-free at (866) 382-5476.
 - E-mail us at cs@dualav.com.
- Exclusion of Certain Damages: This warranty is exclusive and in lieu of any and all other warranties, expressed or implied, including without limitation the implied warranties of merchantability and fitness for a particular purpose and any obligation, liability, right, claim or remedy in contract or tort, whether or not arising from the company's negligence, actual or implied. No person or representative is authorized to assume for the company any other liability in connection with the sale of this product. In no event shall the company be liable for indirect, incidental, or consequential damages.

FCC Compliance

This device complies with Part 15 of the FCC Rules. Operation is subject to the following two conditions:
(1) this device may not cause harmful interference, and
(2) this device must accept any interference received, including interference that may cause undesired operation.

Warning: Changes or modifications to this unit not expressly approved by the party responsible for compliance could void the user's authority to operate the equipment.

Note: This equipment has been tested and found to comply with the limits for a Class B digital device, pursuant to Part 15 of the FCC Rules. These limits are designed to provide reasonable protection against harmful interference in a residential installation. This equipment generates, uses, and can radiate radio frequency energy and, if not installed and used in accordance with the instructions, may cause harmful interference to radio communications. However, there is no guarantee that interference will not occur in a particular installation. If this equipment does cause harmful interference to radio or television reception, which can be determined by turning the equipment off and on, the user is encouraged to try to correct the interference by one or more of the following measures:

- Reorient or relocate the receiving antenna.
- Increase the separation between the equipment and receiver.
- Connect the equipment into an outlet on a circuit different from that to which the receiver is connected.
- Consult the dealer or an experienced radio/TV technician for help.

www.dualav.com
©2024 Dual Electronics Corp. All rights reserved.
NISC24-V01

Wiring Diagram - Inputs/Outputs

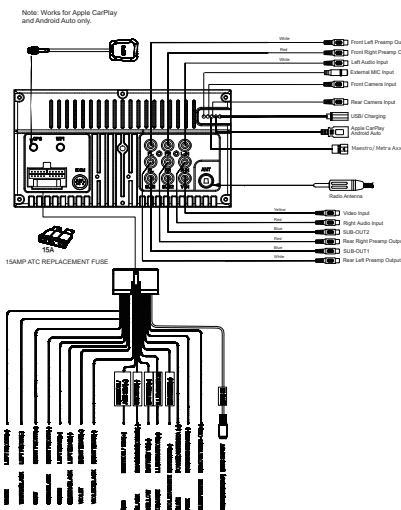

Note: When replacing a fuse, make sure to use the correct type and amperage. Using an incorrect fuse could cause damage. The unit uses (1) 15 amp ATC mini fuse located on the power connector.